

**years
guarantee**

3



AIRTEX®



BOMBA DE AGUA · KIT DE DISTRIBUCIÓN · WATER PUMP · TIMING BELT KIT · WASSERPUMPE · ZAHNRIEMENSATZ · POMPE À EAU · KIT DE COURROIE DE DISTRIBUTION

1

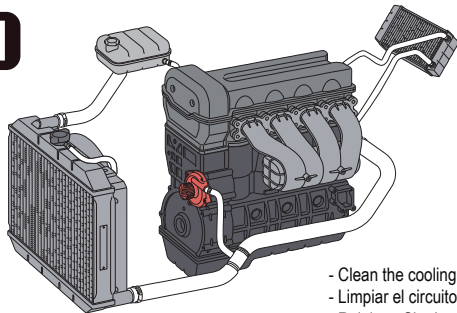

- Clean the cooling system.
- Limpiar el circuito de refrigeración.
- Reinigen Sie das Kühlsystem.
- Nettoyer le système de refroidissement.

2

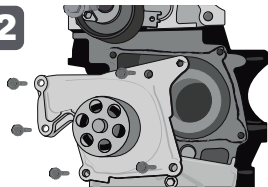

- Remove timing belt kit components and water pump.

3

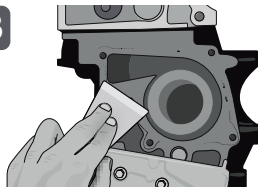

- Clean the block engine.

4

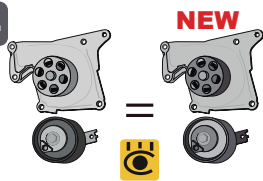

- Check that they are the same parts.

5

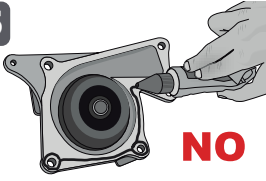

- Not use silicone joint if there is gasket.

6

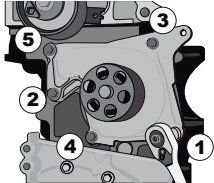

- Fit water pump in right order.

7

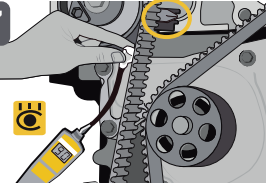

- Replace all timing belt kit components and check the correct belt tension.

8

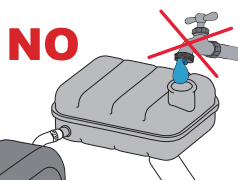

- No water allowed.

9

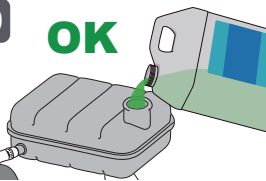

- Use the correct coolant liquid and not reuse the old liquid.



BOMBA DE COMBUSTIBLE · FUEL PUMP · KRAFTSOFFPUMPEN · POMPE À CARBURANT

1

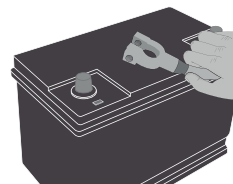

- Disconnect the battery earth lead.

2

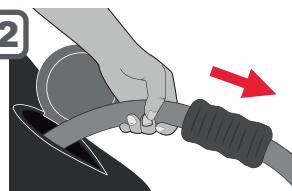

- Drain the fuel of the tank.

3

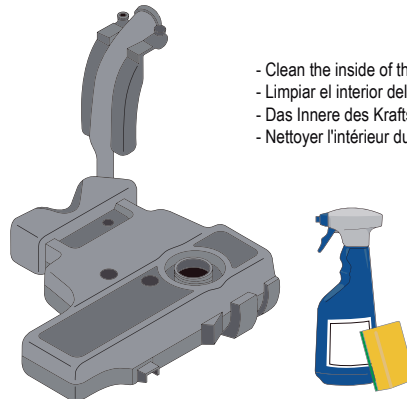

- Clean the inside of the fuel tank.
- Limpiar el interior del depósito de combustible.
- Das Innere des Kraftstofftanks reinigen.
- Nettoyer l'intérieur du réservoir à carburant.

4

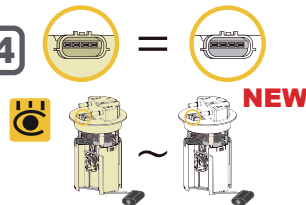

- Check that they are equivalent parts.

5

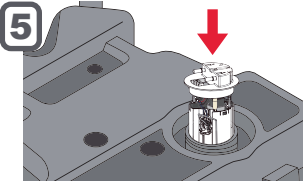

- Fit correctly the fuel pump module.

6

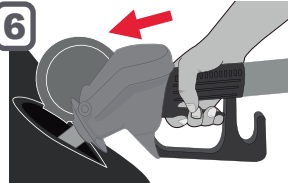

- Fill the fuel tank.

7

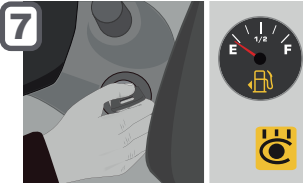

- Switch on the vehicle and check fuel level sender works correctly.

8



- Reset the control unit if the fuel level sender does not work correctly.

9



- Switch on the vehicle and check again fuel level sender works correctly.